

Location Map



- Easy access via major highways - ECP, PIE, TPE
- Short drive to Changi Airport
- Short walk to Changi City Point, a shopping mall housing a supermarket, retail and F&B outlets
- Short walk to Expo MRT station which houses both East-West Line and Downtown Line
- Public bus service to Tampines and Simei MRT stations

maple^{tree}
industrial
 Your Preferred Real Estate Partner

Leasing Enquiries

- ☎ 6377 8000
- ✉ industrial@mapletree.com.sg
- 🌐 www.mapletreeindustrialtrust.com

Mapletree Industrial Trust
 10 Pasir Panjang Road, #13-01, Mapletree Business City, Singapore 117438

Disclaimer: While every reasonable care has been taken in preparing this factsheet, neither Mapletree Industrial nor their appointed marketing agents can be held responsible for any inaccuracy or changes and any loss or damage arising therefrom. All information and specifications are subject to changes as may be approved or required by the relevant authorities and shall not form part of an offer or contract. All interested parties should satisfy themselves by inspection and enquiry as to the accuracy of the particulars which are believed to be correct but are not regarded as statements or representations of fact.

THE SIGNATURE - LEVEL 2 TYPICAL FLOOR PLAN

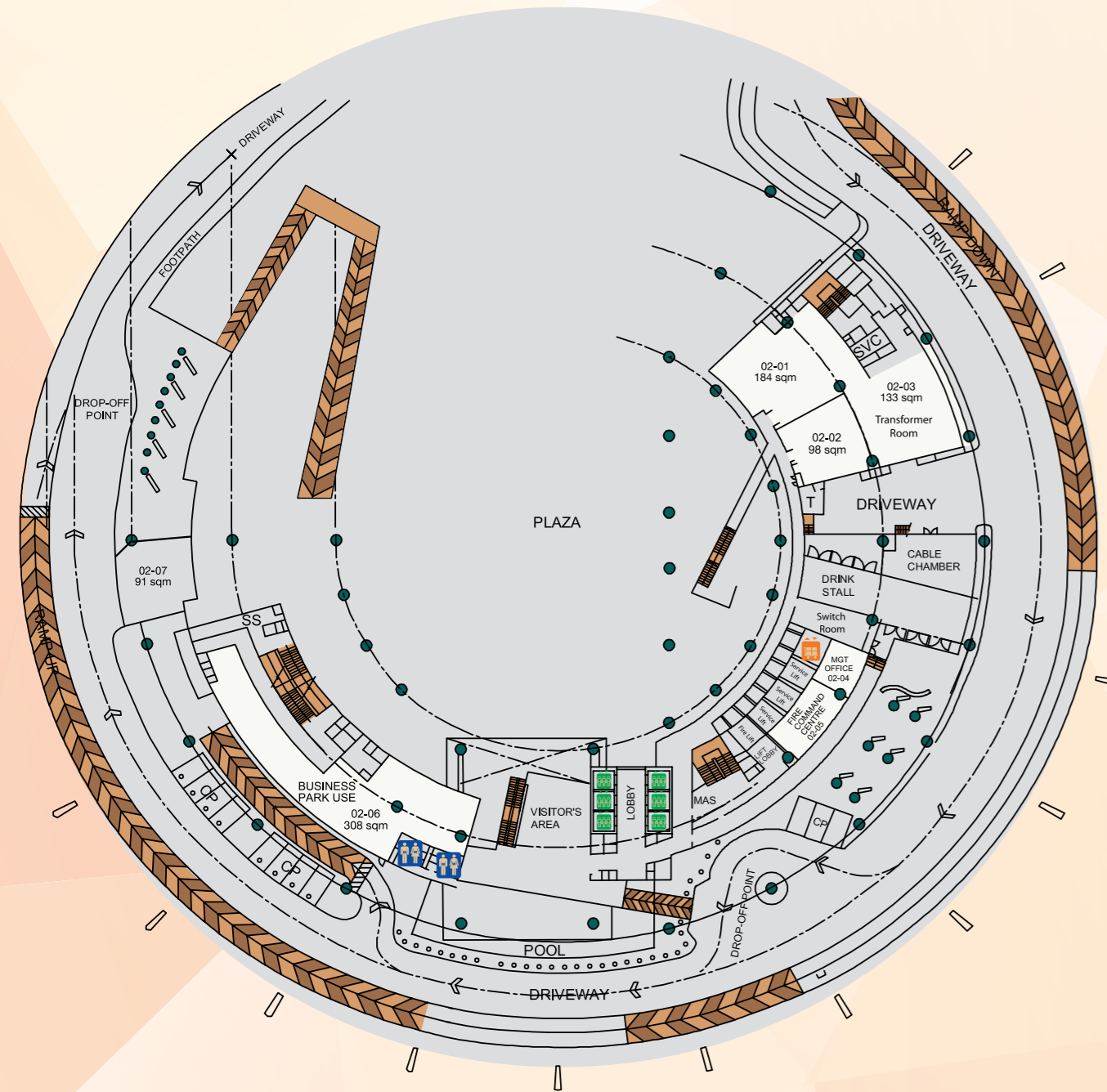

The Signature

Changi Business Park Central 2
 Singapore 486066

General Information

Building Type • Business Park	Zoning • Business 1	Gross Floor Area • 47,410 sqm	Net Lettable Area • 31,906 sqm
Total Units • 116	Unit Sizes • 36 – 1,327 sqm	Parking Lots • 349	Amenities • Foodcourt, restaurants, banks, childcare centre, retail shops

Technical Specifications

Floor Loading • 1st, 2nd, 4th – 9th Floor: 5 KN/sqm • 3rd Floor: 7.5 KN/sqm • Loading / Unloading Bay: 20 KN/sqm • Staircases: 4 KN/sqm	Floor to Ceiling Height • 2.8 m	Loading/Unloading • 3 loading bays & 1 dock leveller	Passenger Lift • 6 nos.
Fire Protection • Automatic electric fire alarm & sprinkler system • Smoke detectors • Dry riser hoses • Fire hydrant • Manual call points	Power Supply Allocation • 300 VA/sqm	Building Management • Central Management System is provided for control and monitoring of building services, maintenance service & energy usage	Fireman Lift • 1 no. / 2,040 kg
	Emergency Systems • 2 nos. / 850 KW generator	Lighting • Recessed fluorescent lightings with Exit signs	Cargo/Service Lift • 3 nos. / 2,040 kg & 3,000 kg (serving 1st & 3rd – 9th Floor only)
	Building Security • 24h security with guards & CCTV		
	Air-Conditioning • Centralised chilled water system		



The Signature is an iconic landmark nine-storey building located in the heart of Changi Business Park. The development is designed for research and development, knowledge-intensive and backroom operations such as data processing, call centres, etc. Amenities and facilities such as hotels, service apartments, convention centre and fitness centre are located nearby.

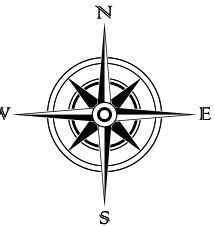

THE SIGNATURE - LEVEL 3 & 4 TYPICAL FLOOR PLAN

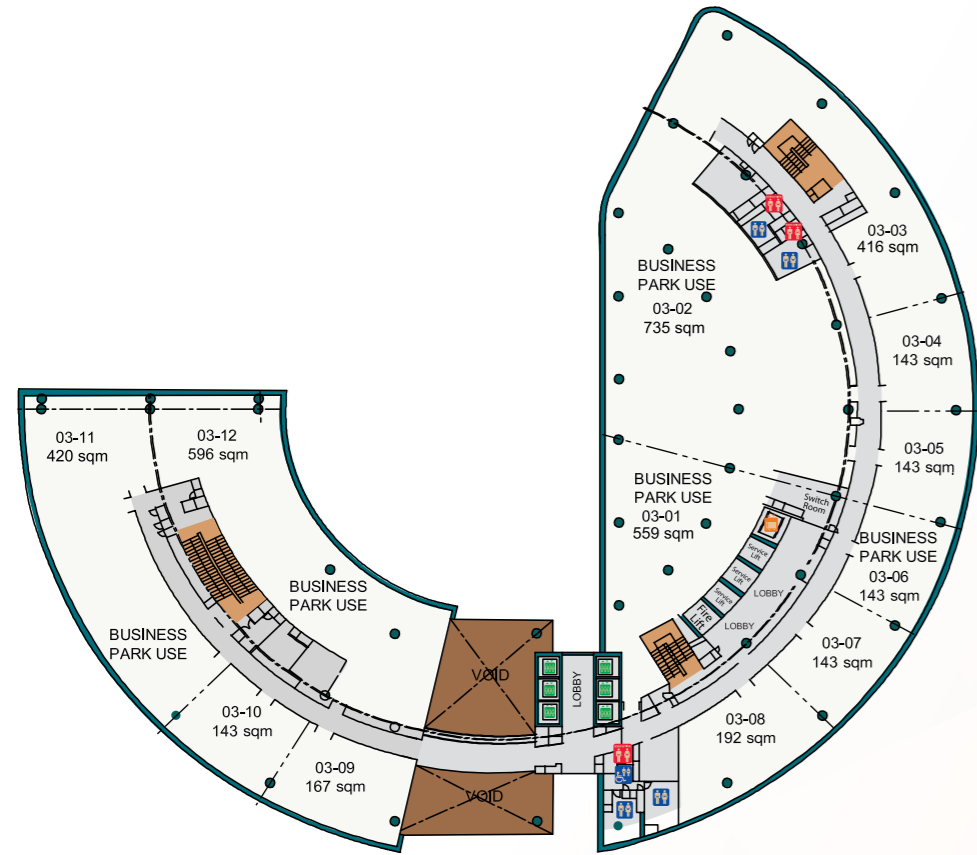

THE SIGNATURE - LEVEL 8 TYPICAL FLOOR PLAN

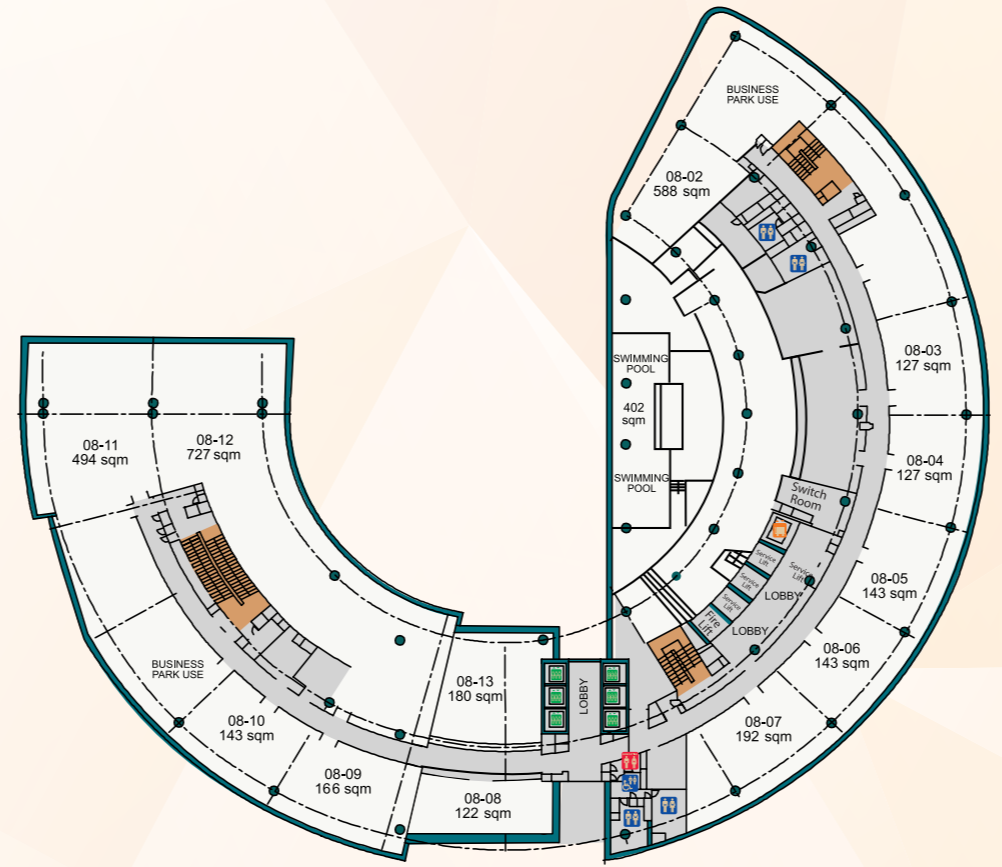

THE SIGNATURE - LEVEL 1 TYPICAL FLOOR PLAN

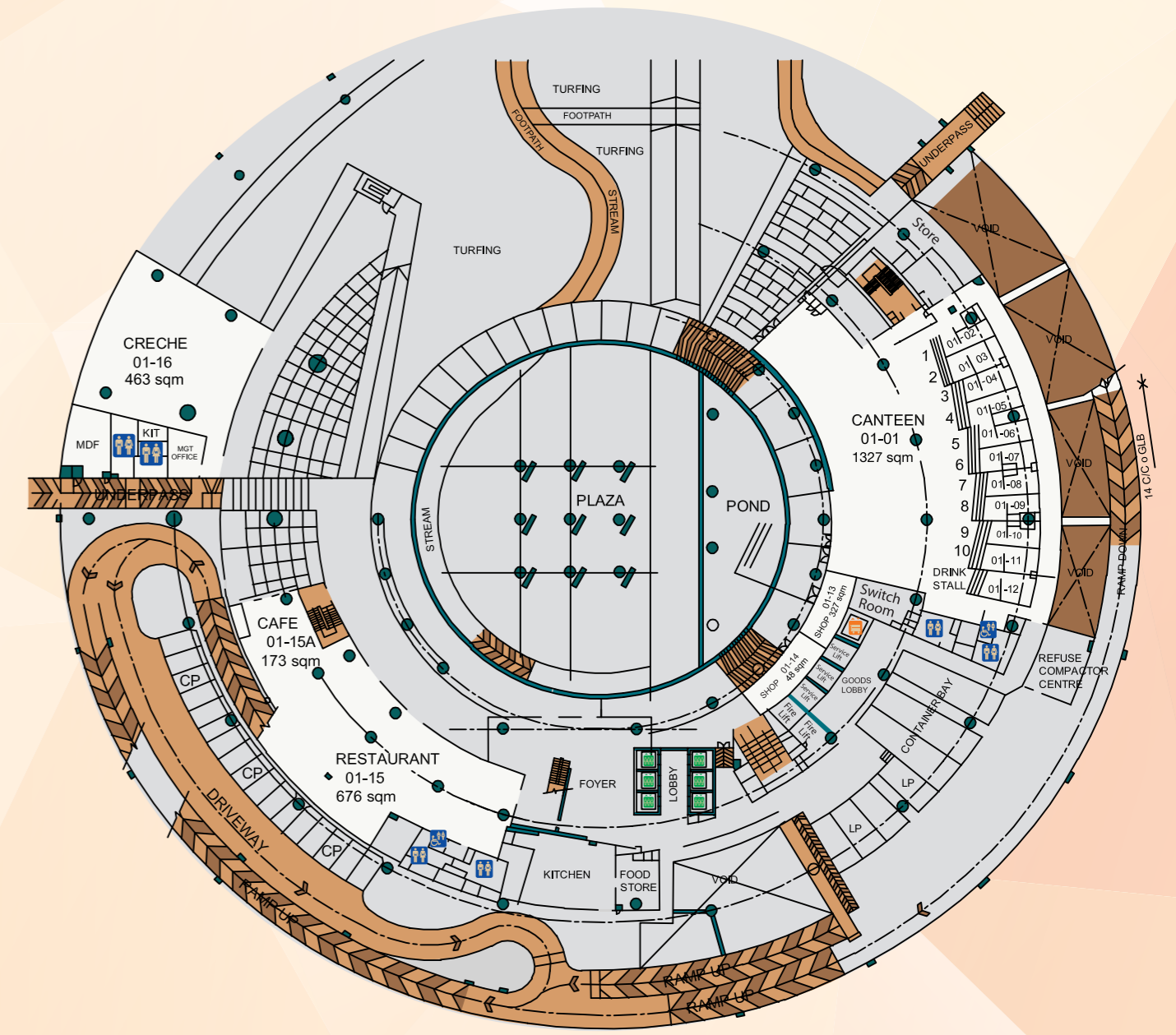

THE SIGNATURE - LEVEL 5 TO 7 TYPICAL FLOOR PLAN

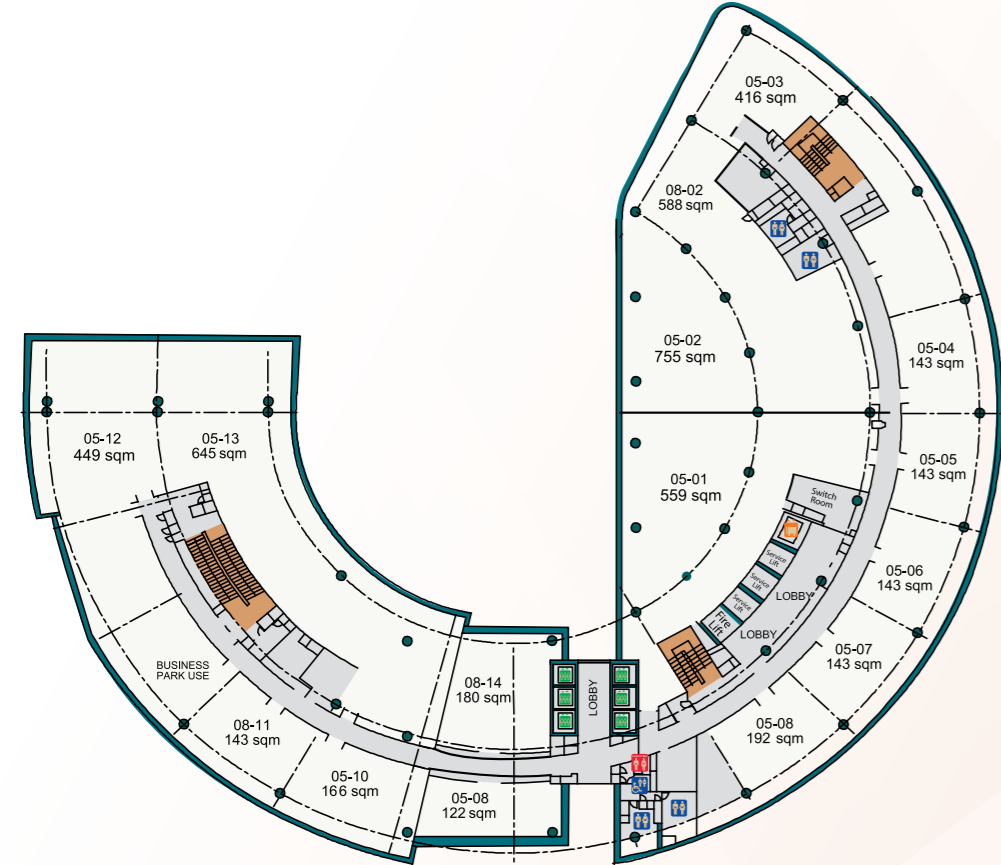

THE SIGNATURE - LEVEL 9 TYPICAL FLOOR PLAN

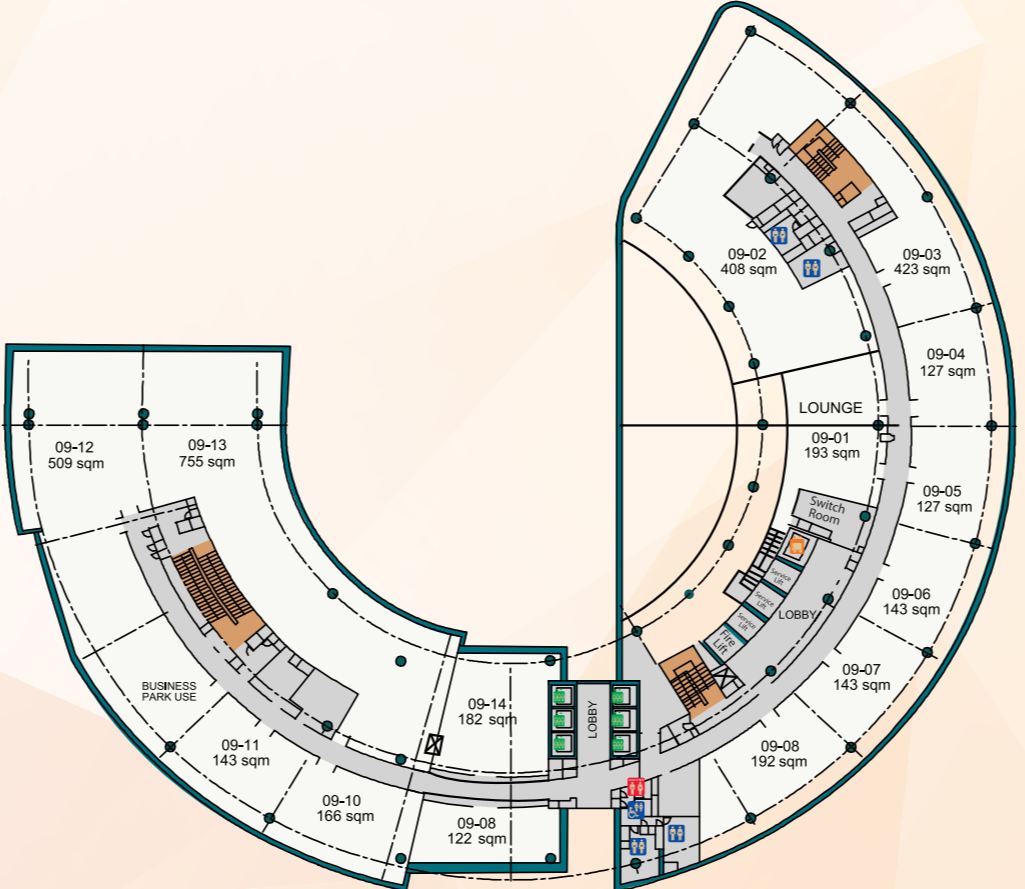

Toilet



Executive Toilet



Passenger Lift



Goods Lift